

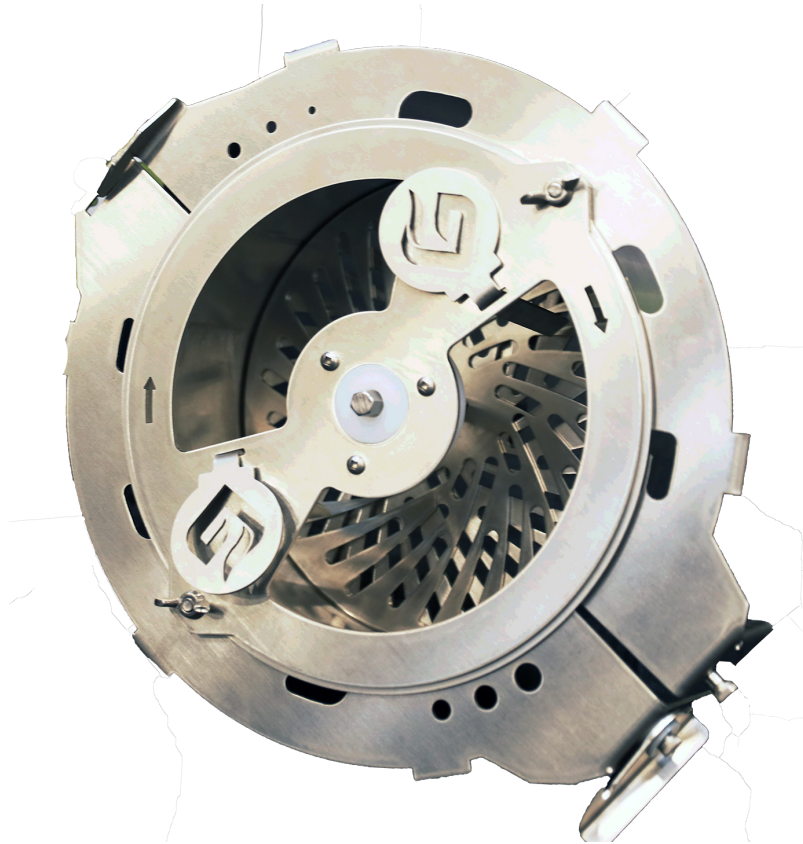

**GREENBROZ**



# **THE HARVEST BUCKET**

## **User Manual**

**GreenBroz.com**

# SAFETY INSTRUCTIONS

Users shall never place their hands into the bucket during operation. If, at any time, the user needs to put their hands into the trimming area the drill must be detached from the trimming shaft and safely stored away from the bucket.



This machine has rotating parts and pinch points that can cause serious injury. When powering the machine, ensure that all guards, assemblies, and accessories have been properly installed. Absolutely no loose hair, clothes, jewelry, or accessories permitted when operating.



## CAUTION

### ROTATING MECHANICAL PARTS

Rotating machine parts have the potential to cause severe injury or death. All components must be fully secured before operation and are essential for protecting operators. Never place hands or head near the machine during operation.

# TECHNICAL SPECIFICATIONS

## Dimensions:

34.78 cm (13.692") x 30.66 cm (12.069") x 14.61cm (5.75")

**Weight:** 3.73 kg (8.23 lbs.)

**Ideal speed:** 20-40 RPM

**Construction:** Made up of food safe materials, including surgical 316 stainless steel

# OPERATING INSTRUCTIONS

## Trimming:

After properly assembling the Bucket Trimmer, as shown in the assembly portion of this manual, the drill is able to be attached. The trimming shaft is able to be fixed to the drill like any normal drill bit. Open the chuck until the hex shaft slides in and then full tighten down while making sure the shaft is not crooked. The shaft is now able to be slid into place for trimming. Ensure the shaft is fully recessed into both plastic seats before operating. With the shaft in place, rotate clockwise at low RPM until you have your desired finish. Note: High RPM can cause damage to the machine or material.

# OPERATING INSTRUCTIONS

## Bucking:

Some buckets come with a bucking feature built into the clamp itself. There are various different geometries that will work for most sized plants. Using the side of the clamp with beveled edges, it is recommended to simply thread the bottom of the plant through the provided holes and pull through manually. Ensure to hold the same side of the clamp that is being used to buck

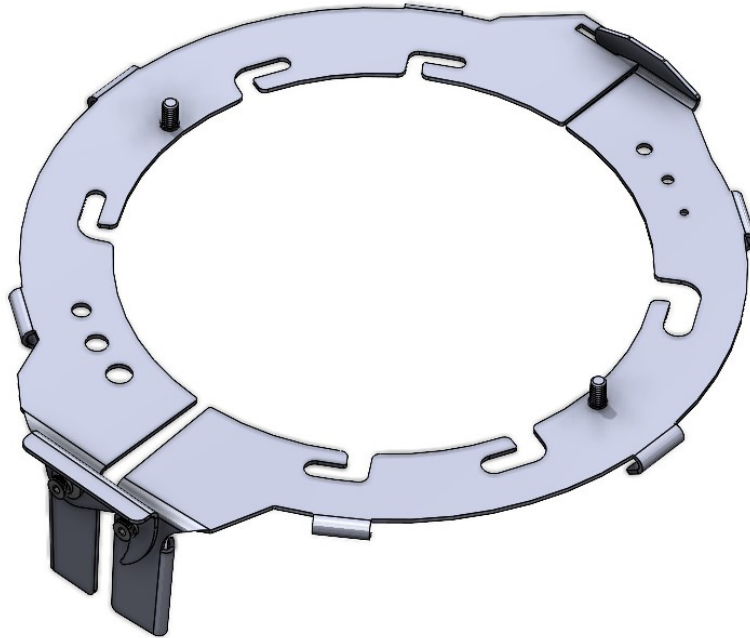

### SCAN QR Code

to see the  
How to Operate Harvest  
Bucket Video



# CLEANING INSTRUCTIONS

## Tools required for deep cleaning: flat head screwdriver

The machine breaks down for general cleaning without any tools required. For a deeper clean of each of the components, the tools listed above are required. The surfaces that come in direct contact with your material should be paid special attention to. The stainless-steel components are able to be power washed and sanitized with chemicals as needed. Keep chemicals and high-pressure water away from the plastic components when cleaning, soap and water with a rough sponge is recommended.

# ASSEMBLY INSTRUCTIONS

## Assembly Instructions Step One:

The Bucket Clamp has two sides that hook together as shown in the image. The clamp is designed to clamp over the top rim of a 5-gallon bucket. After clamp assembly is placed over a bucket, squeeze the vertical handles together and rotate the bucket latch into the locked position.

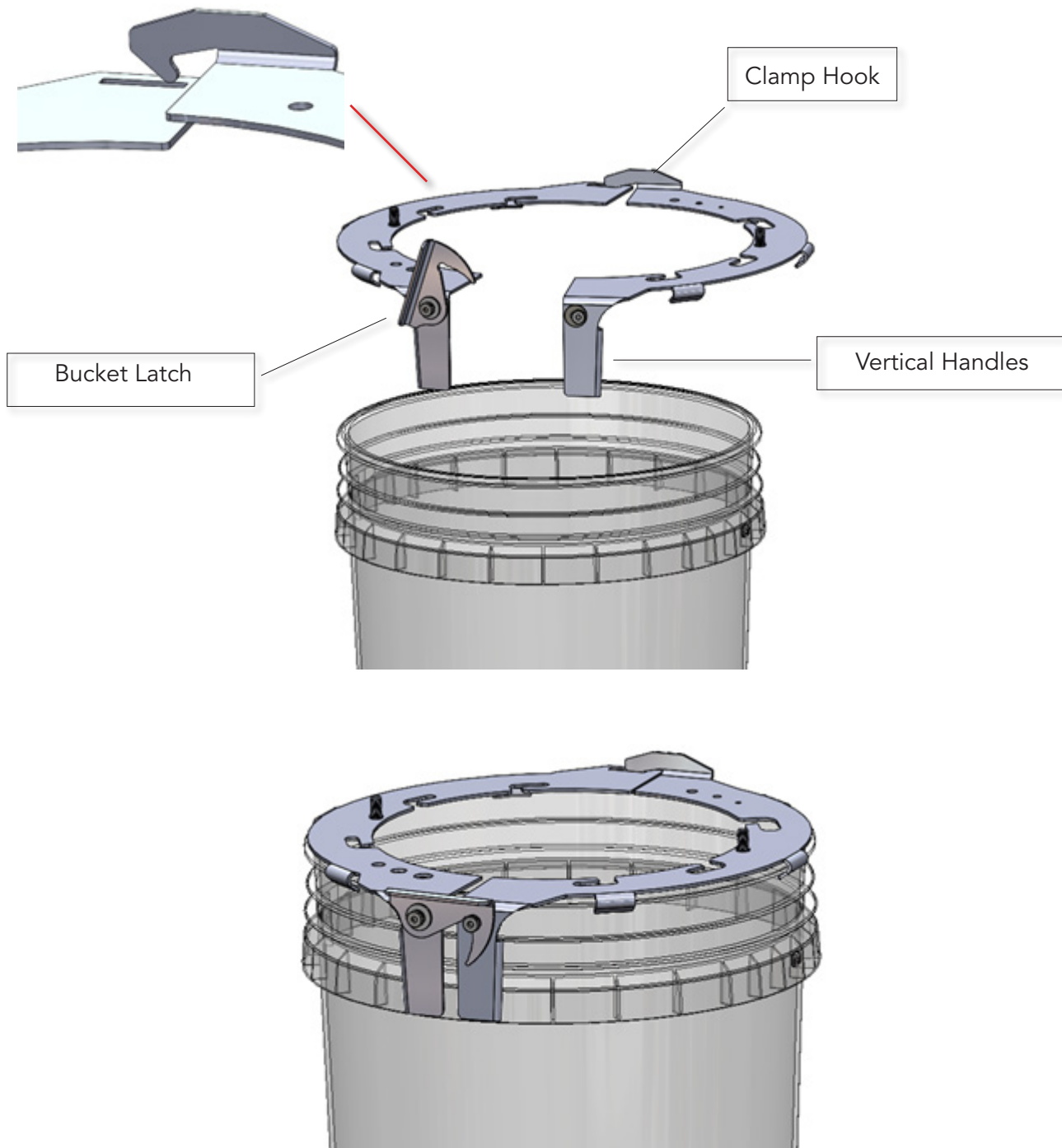

# ASSEMBLY INSTRUCTIONS

## **Assembly Instructions Step Two:**

Install the Internal Bucket into the clamp with the threaded studs passing through the slots.

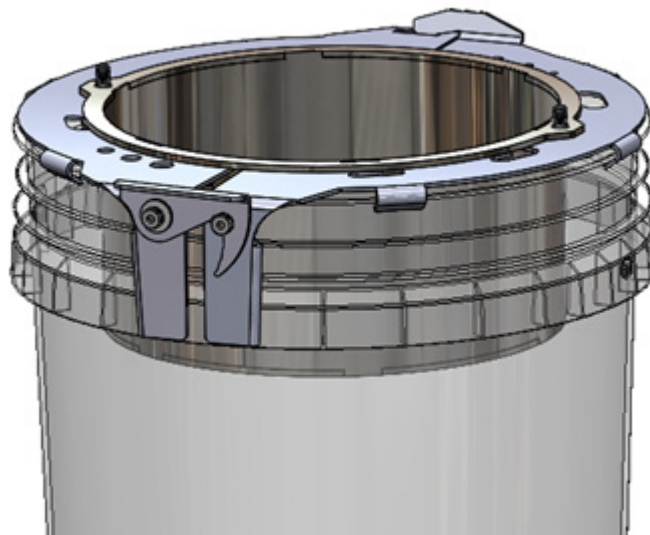
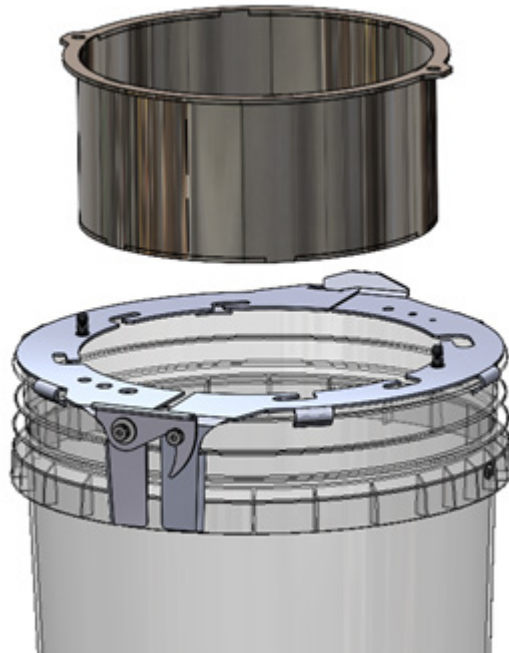

# ASSEMBLY INSTRUCTIONS

## Assembly Instructions Step Three:

Both the top and bottom blades are only dropped into place. It is important to note that the bottom blade is placed first and that the blades should be facing opposite directions as shown. The Trim Plate comes next and is secured with the supplied wing nuts. The shaft and GBZ tines slide into position. Ensure to place the GBZ tines so that their faces are resting on the Trimming Plate as shown below.

Fix your drill to the 3/8" hex shaft and rotate clockwise at low RPM (below 50 rpm) until you have your desired finish.

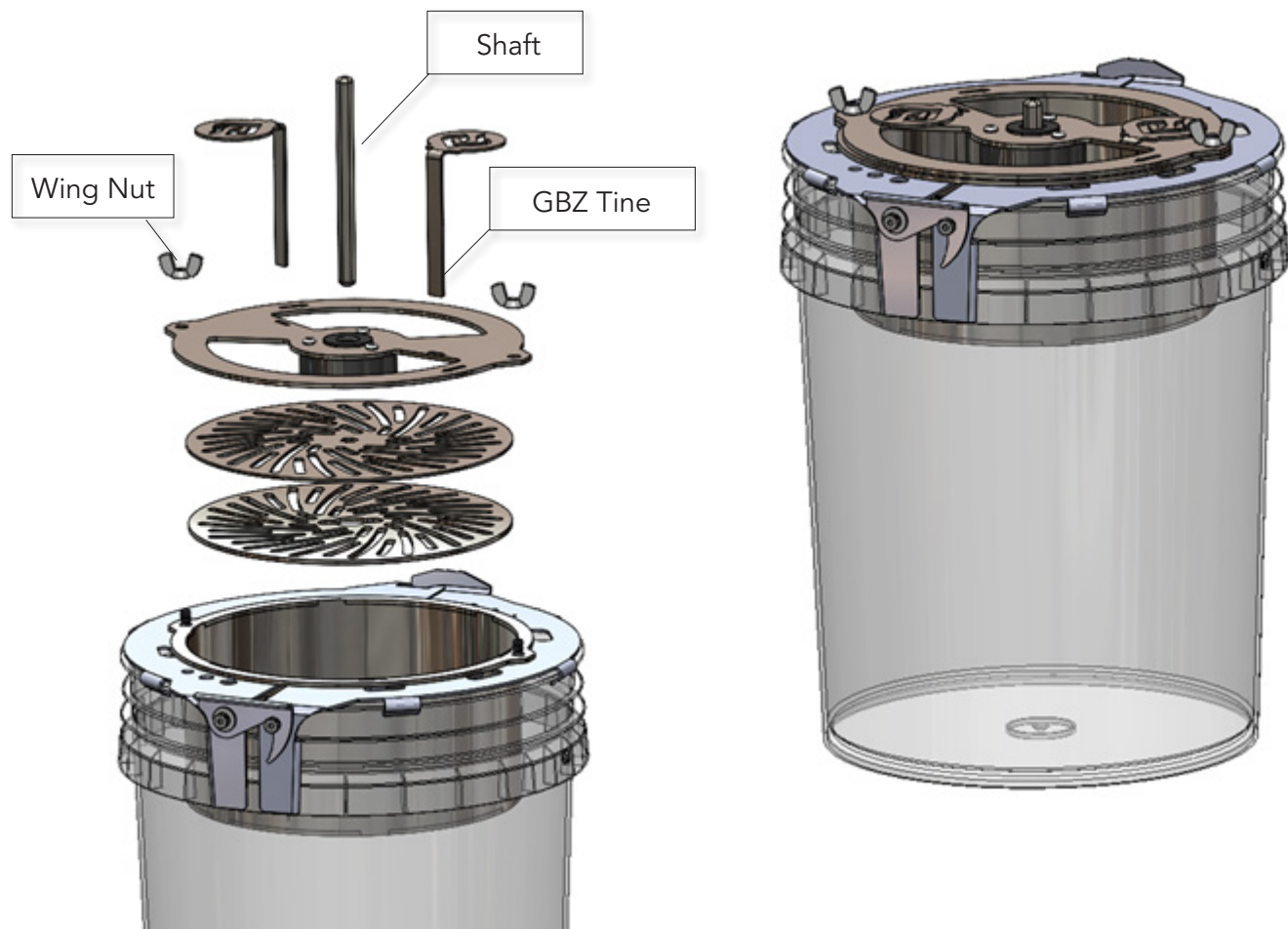

### SCAN QR Code

to see the  
How to Assemble  
the Harvest  
Bucket Video

